

**INFORMATION**

Stairs information to get between floors is shown on Page 2 - Mezzanine Level Map

**STEPS** is the number of steps to get onto the next level

**RISE** is the maximum step height per step (unless Total is stated)

**TREAD** is the minimum front to back length of each step

**WIDTH** is the minimum side to side length for the area (usually door width)

**Entrance 1 - Fire Main**

Steps: 2 or 3  
Rise: 9cm total  
Tread: 30cm min  
Width: 120cm min

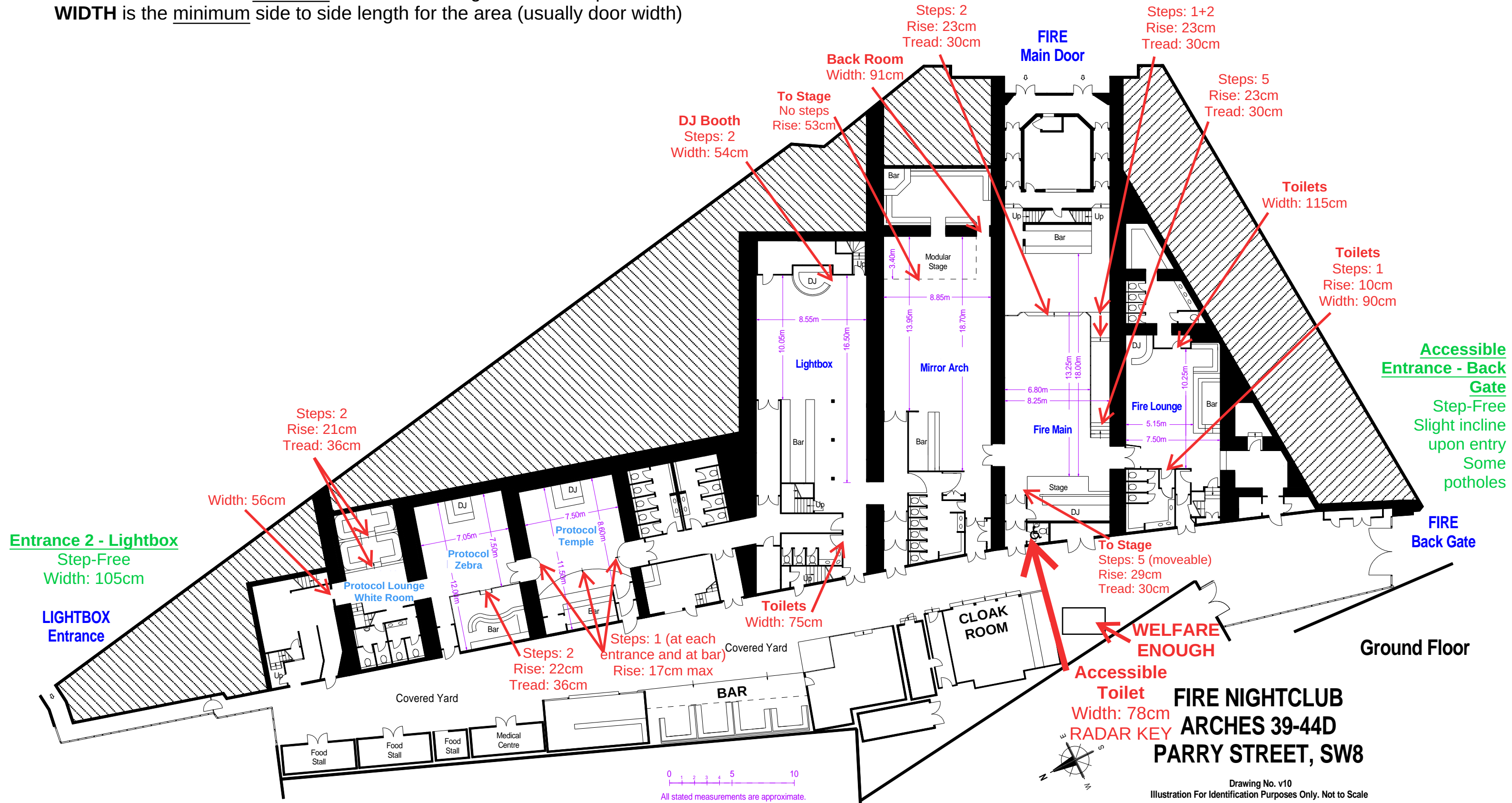

0 1 2 3 4 5 10  
All stated measurements are approximate.  
Check all measurements on site.

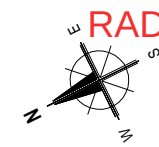

**FIRE NIGHTCLUB**  
**ARCHES 39-44D**  
**PARRY STREET, SW8**

Drawing No. v10  
Illustration For Identification Purposes Only. Not to Scale  
Copyright © BluePrint Floorplans Ltd. 2018  
info@blueprintfloorplans.co.uk

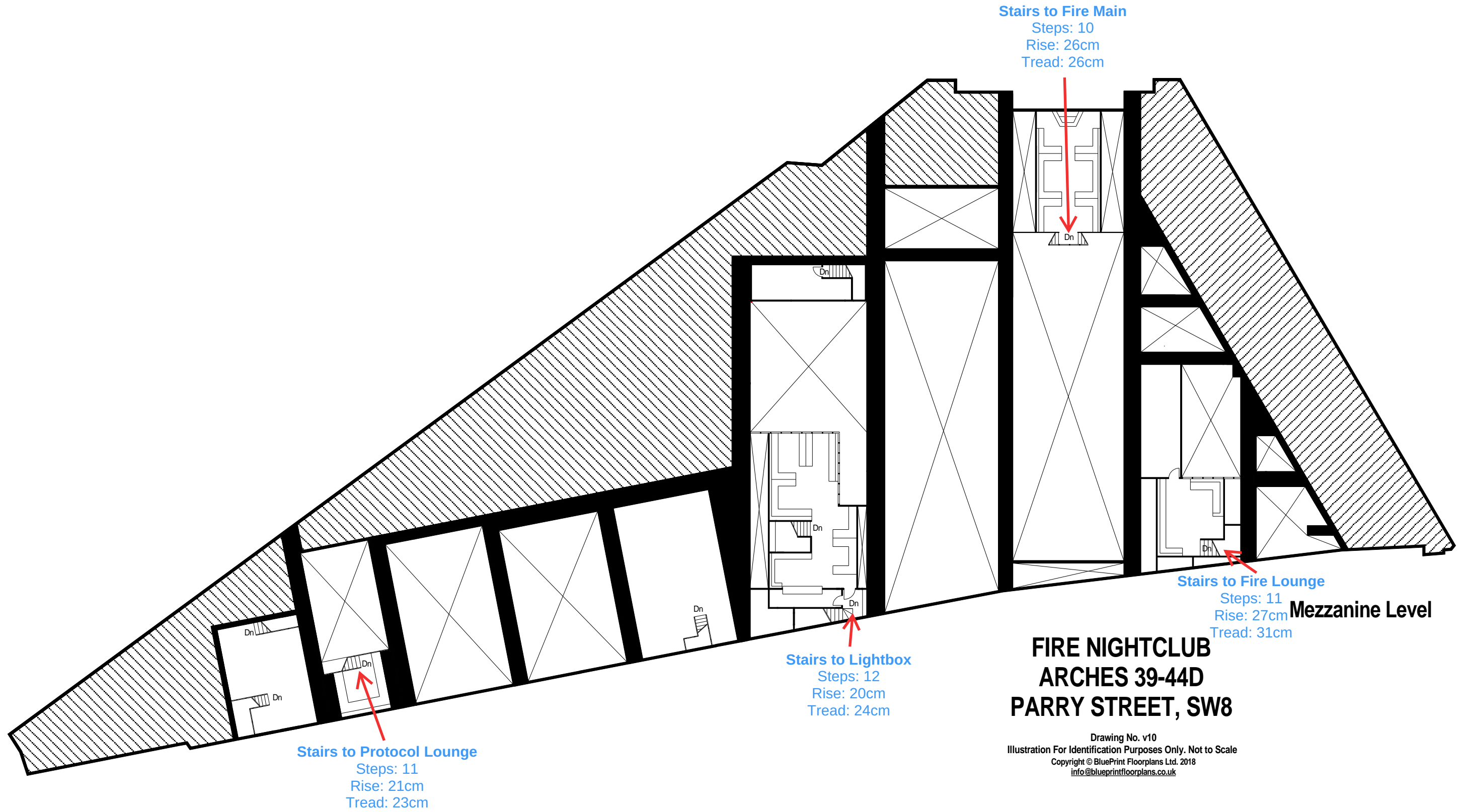

Stairs to Fire Main  
 Steps: 10  
 Rise: 26cm  
 Tread: 26cm

Stairs to Fire Lounge  
 Steps: 11  
 Rise: 27cm  
 Tread: 31cm  
**Mezzanine Level**

Stairs to Lightbox  
 Steps: 12  
 Rise: 20cm  
 Tread: 24cm

Stairs to Protocol Lounge  
 Steps: 11  
 Rise: 21cm  
 Tread: 23cm

**FIRE NIGHTCLUB  
 ARCHES 39-44D  
 PARRY STREET, SW8**

Drawing No. v10  
 Illustration For Identification Purposes Only. Not to Scale  
 Copyright © Blueprint Floorplans Ltd. 2018  
[info@blueprintfloorplans.co.uk](mailto:info@blueprintfloorplans.co.uk)